

PF



**Pallet fork  
for Loader and  
backhoe Loader**

**Pallet fork  
for Skid-Steer Loader**





## Technical Specification



Pallet forks, for Skid-Steer Loader, Loader or Backhoe Loader with manual side shift frame and protection grid (only in Skid-Steer Loader model)

**2 high lifting capacity forks** manual with manual side shift.

# Pallet fork

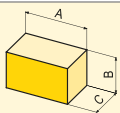
MODEL		Skid - Steer Loader				Loader and Backhoe Loader		
		PF 100	PF 120	PF 130	PF 150	PF 250	PF 450	
Technical specification	um							
Max lifting capacity <sup>(1)</sup> Q	kg	1000		1800	2500	2500	4500	
Weight standard configuration	kg	120	145	185	230	260	380	
Forks section ExF	mm	80x30		100x35	100x40	100x40	120x50	
Forks length C	mm	1000		1100	1200	1200		
Frame width L	mm	1000	1200	1300	1500	1500		
Frame height H	mm	900	950		450		540	
Center of gravity B	mm	500				500		
	ton	1,3-1,6	1,6-2,6	2,6-3,5	3,4-4,8	-	-	
	ton	-	1,5-3,0	2,8-4,0	4,0-6,2	4,0-6,2	6,0-12,0	
	ton	-	2,0-3,4	3,0-4,6	4,5-6,5	4,5-6,5	6,2-9,0	
	Overall size in standard configuration	A cm	100	120	130	150	150	150
		B cm	90	95	95	95	54	54
		C cm	110	121	131	141	124	125

(1) Maximum lifting capacity "Q" is for load centre of gravity in central position between the forks.

## WORKING DIMENSIONS

Pallet fork for skid loader

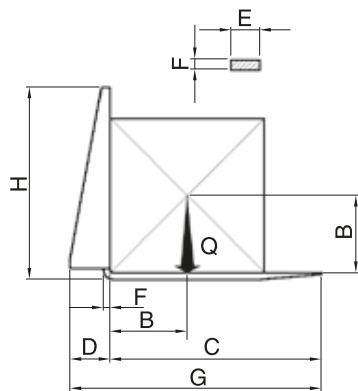
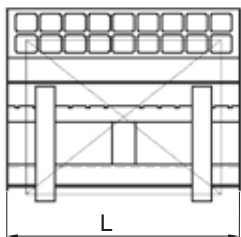

Pallet fork for loader and backhoe loader

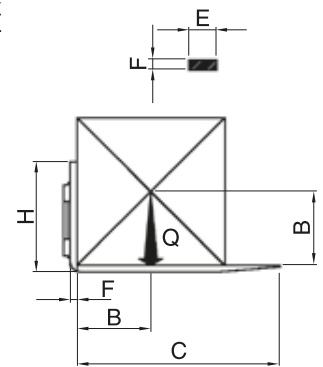
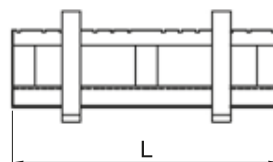

Data, descriptions and images of this document are not binding hence GF Gordini reserves the right to alter part or all of them at any time with no notice.